



VOTER'S GUIDE

2020 PROVINCIAL GENERAL ELECTION



Vote safely in person

Voting places will be open **October 15 to October 21**, and on election day, **October 24**. Find the one nearest you at wheretovote.elections.bc.ca

OR



Vote by mail

Request your voting package as soon as possible: visit votebymail.elections.bc.ca or call **1-800-661-8683**



ELECTIONS BC

A non-partisan Office of the Legislature

elections.bc.ca / 1-800-661-8683

TABLE OF CONTENTS



A provincial election has been called	1
Important dates and reminders	2
Voting safely and COVID-19	3
Your in-person voting options	6
Voting by mail	8
Services for at-risk voters and voters with disabilities	11

A PROVINCIAL ELECTION HAS BEEN CALLED



**A provincial election has been called for
Saturday, October 24, 2020.**



Eligible voters in B.C. are voting to elect 87 Members of the Legislative Assembly. Each Member represents an electoral district (also known as a riding or constituency) and has a seat in the provincial Legislature.

You can vote in the provincial election if you are:

- 18 or older on **October 24, 2020**,
- a Canadian citizen, and
- a resident of B.C. since **April 23, 2020**.

Voting in this election will be different because of the COVID-19 pandemic. Elections BC has been working with the Office of the Provincial Health Officer to ensure the voting process is safe and accessible. We want to make sure voters don't have to choose between safeguarding their health and exercising their right to vote.

All voters have the option of voting in person or by mail. Protective measures including physical distancing will be in place at all in-person voting opportunities.

Important Dates & Reminders

If you wish to vote by mail, request a voting package from Elections BC as soon as possible.

Visit votebymail.elections.bc.ca or call **1-800-661-8683**.

Elections BC **must receive** your completed voting package by 8 p.m. Pacific time on **October 24, 2020**. Return your package as soon as possible to make sure it is received by the deadline.

1 p.m. Pacific time October 2	Candidate nominations close. <i>The final list of candidates will be posted at elections.bc.ca.</i>
October 15 to October 21	Advance voting <i>Voting places across the province open from 8 a.m. to 8 p.m. (local time).</i>
October 24	Election day <i>Voting places across the province open from 8 a.m. to 8 p.m. (Pacific time).</i>

Visit elections.bc.ca for the most current information.



Protective measures will be in place at voting places to help voters vote safely during the pandemic. Pandemic voting protocols have been developed in consultation with the Office of the Provincial Health Officer. Here's what you can expect if you vote in person:

- Physical distancing
- Voting place capacity limits
- Election officials wearing personal protective equipment (such as masks and face-visors)
- Protective barriers
- Hand sanitizing stations
- Frequent cleaning of voting stations and frequently touched surfaces
- Election workers trained on safe workplace guidelines and pandemic protocols

Voting places will follow the practices outlined in our voting place safety plan which includes input provided by WorkSafeBC.

Some familiar voting procedures may be different. For example, you will make a verbal declaration of your eligibility to vote instead of signing a voting book.

Follow the instructions from election officials and signage in the voting place to help maintain physical distancing. You will be asked to sanitize your hands before and after voting.

If you are ill or self-isolating, **do not visit a voting place**. Request a vote by mail package or call Elections BC at 1-800-661-8683 for assistance.

Learn more at elections.bc.ca/safevoting.



What should I bring if I vote in person?

- ID that shows your name and home address. See elections.bc.ca/id for the list of acceptable ID.
- Your Where to Vote card. Look for it in the mail from Elections BC. Bringing it with you to the voting place will make voting faster and easier.
- Your own pen or pencil to mark your ballot, if you wish.
- A mask to wear in the voting place, if you wish. We encourage voters to wear a mask when they vote to protect others. You will not be asked to remove your mask to vote.

This is what your Where to Vote card will look like.

Front



PROVINCIAL GENERAL ELECTION



A provincial election has been called for **Saturday, October 24, 2020**. For information about where, when and how to vote, refer to the other side of this card or visit elections.bc.ca.

Voting safely in person during COVID-19

Pandemic protocols will be in place at voting places to help you vote safely during COVID-19. Follow the instructions from election officials at the voting place. If you are feeling sick or self-isolating, stay home. Request a vote-by-mail package or contact Elections BC for more voting options. Visit elections.bc.ca/COVID19 for more information.

Vote by mail

Voting by mail isn't just for voters who will be away during the election. It's an option for all eligible voters. It is a good option for voters who aren't comfortable voting in person at a voting place.

If you wish to vote by mail, request a voting package from Elections BC as soon as possible. Visit elections.bc.ca or call 1-800-661-1111 for more information.



VTB-001



GENERAL VOTING DAY

Remember to bring this card and ID. Voting will be open from 8 a.m. to 8 p.m. (Pacific time).

On Saturday, October 24, you can vote at:

General Voting Place
100 Main St, Victoria BC



Your address is:
1234 Main St, Victoria BC

Deliver to:

FIRSTNAME LASTNAME
1234 MAIN ST
VICTORIA BC V1V 1V1

ADVANCE VOTING

Advance voting places are wheelchair accessible and open from 8 a.m. to 8 p.m. (local time) on the dates checked.

- Advance voting place 1, 100 Main St, Victoria, BC
- Advance voting place 2, 200 Main St, Victoria, BC
- Advance voting place 3, 300 Main St, Victoria, BC
- Advance voting place 4, 400 Main St, Victoria, BC
- Advance voting place 5, 500 Main St, Victoria, BC
- Advance voting place 6, 600 Main St, Victoria, BC

DATES OPEN

	Thurs Oct 15	Fri Oct 16	Sat Oct 17	Sun Oct 18	Mon Oct 19	Tues Oct 20	Wed Oct 21
Advance voting place 1, 100 Main St, Victoria, BC	✓	✓		✓	✓	✓	✓
Advance voting place 2, 200 Main St, Victoria, BC	✓	✓		✓	✓	✓	✓
Advance voting place 3, 300 Main St, Victoria, BC		✓	✓		✓	✓	✓
Advance voting place 4, 400 Main St, Victoria, BC	✓	✓				✓	✓
Advance voting place 5, 500 Main St, Victoria, BC			✓	✓			
Advance voting place 6, 600 Main St, Victoria, BC			✓	✓	✓		

Back



YOUR IN-PERSON VOTING OPTIONS



Pandemic protocols will be in place at all in-person voting opportunities. See page 3 for more information.

Vote at advance voting

October 15 to October 21 | 8 a.m. to 8 p.m. (local time)

You don't need a special reason to vote at advance voting – it's an option for all voters. Note that some advance voting places may not be open on every advance voting day. Find advance voting places and the dates they are open at **[wheretovote.elections.bc.ca](https://www.wheretovote.elections.bc.ca)** or on your Where to Vote card.

Vote on election day

October 24 | 8 a.m. to 8 p.m. (Pacific time)

Voters have an assigned voting place on election day. Normally it is faster to vote at your assigned voting place, but you can vote at another voting place if it is more convenient to you. Find your assigned voting place at **[wheretovote.elections.bc.ca](https://www.wheretovote.elections.bc.ca)** or on your Where to Vote card.

Voting Places

Voting places are still being confirmed, but will be available:

- on Elections BC's website at **[wheretovote.elections.bc.ca](https://www.wheretovote.elections.bc.ca)**
- on Where to Vote cards sent to every registered voter before advance voting starts, and
- by calling **1-800-661-8683**

Vote at a district electoral office

From now until 4 p.m. (Pacific time) on **October 24**.

You can vote or pick up a vote-by-mail package at any district electoral office in the province. Offices are open from 9 a.m. to 5 p.m. Monday to Friday, and Saturdays 10 a.m. to 4 p.m. Offices will be open from 8 a.m. to 8 p.m. during advance voting. Find a list of office locations at **elections.bc.ca/deo**.

VOTING BY MAIL



Voting by mail isn't just for voters who will be away during the election. It's an option for all eligible voters. Voting by mail is a great option for voters who are not comfortable voting in person because of the pandemic.

If you wish to vote by mail, contact Elections BC to request a vote-by-mail package as soon as possible. Your package will be mailed to you. You can ask for one by:

- Visiting **votebymail.elections.bc.ca**
- Calling Elections BC at **1-800-661-8683**

If you would like to pick up your vote-by-mail package in person, contact the closest district electoral office. Visit **elections.bc.ca/deo** or call Elections BC for a list of locations.

Instructions on completing your vote-by-mail package are included in the package. If you are not a registered voter or your information is out of date, you will also find instructions in the voting package on how to register or update your information.

This is what your Vote By Mail Package will look like.

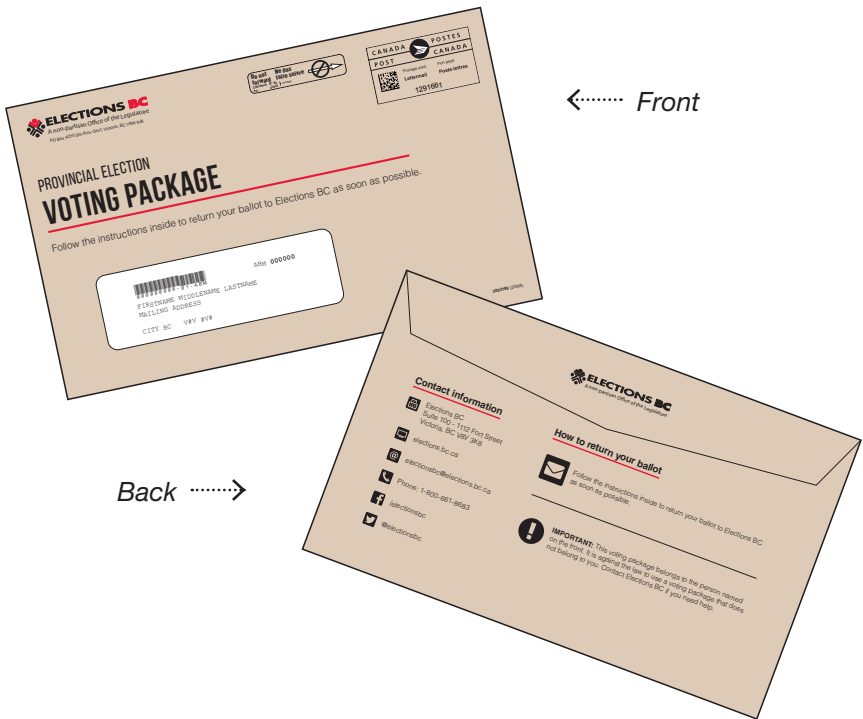

You can return your vote-by-mail package in person at any district electoral office, voting place or Service BC location.

You may also return your package by mail. A postage paid return envelope is provided for voters in Canada. If mailing from outside of Canada, you must provide the necessary postage.

Completed vote-by-mail packages **must be received** by Elections BC before 8 p.m. (Pacific time) on **October 24, 2020**. Voters are encouraged to return their package as soon as possible to make sure it is received by the deadline.

SERVICES FOR AT-RISK VOTERS AND VOTERS WITH DISABILITIES



Voters who are at-risk may be worried about voting in person. Elections BC is committed to a safe and accessible election for all voters, and we have services available to help, whether you are voting in person or remotely. Election officials are trained on how to help voters access voting opportunities, and services are available to help voters with disabilities or underlying health conditions to vote.



Getting help marking your ballot

Voters can get help marking their ballot if they have a disability or difficulty reading or writing. Tell the election official at the voting place if you need help marking your ballot.



Resources for blind or sight-impaired voters

Braille candidate lists, large print ballot posters and plastic ballot templates are available at all voting places to help blind or sight-impaired voters mark their ballot.

Voting place accessibility

All advance voting places and most general voting places are wheelchair accessible. Voters who can't enter a voting place can vote outside the building (at the curb or in the parking lot).

Translators

Voters can bring a translator to help them at the voting place. The translator must make a declaration that they are able to act as a translator and will do so to the best of their abilities.

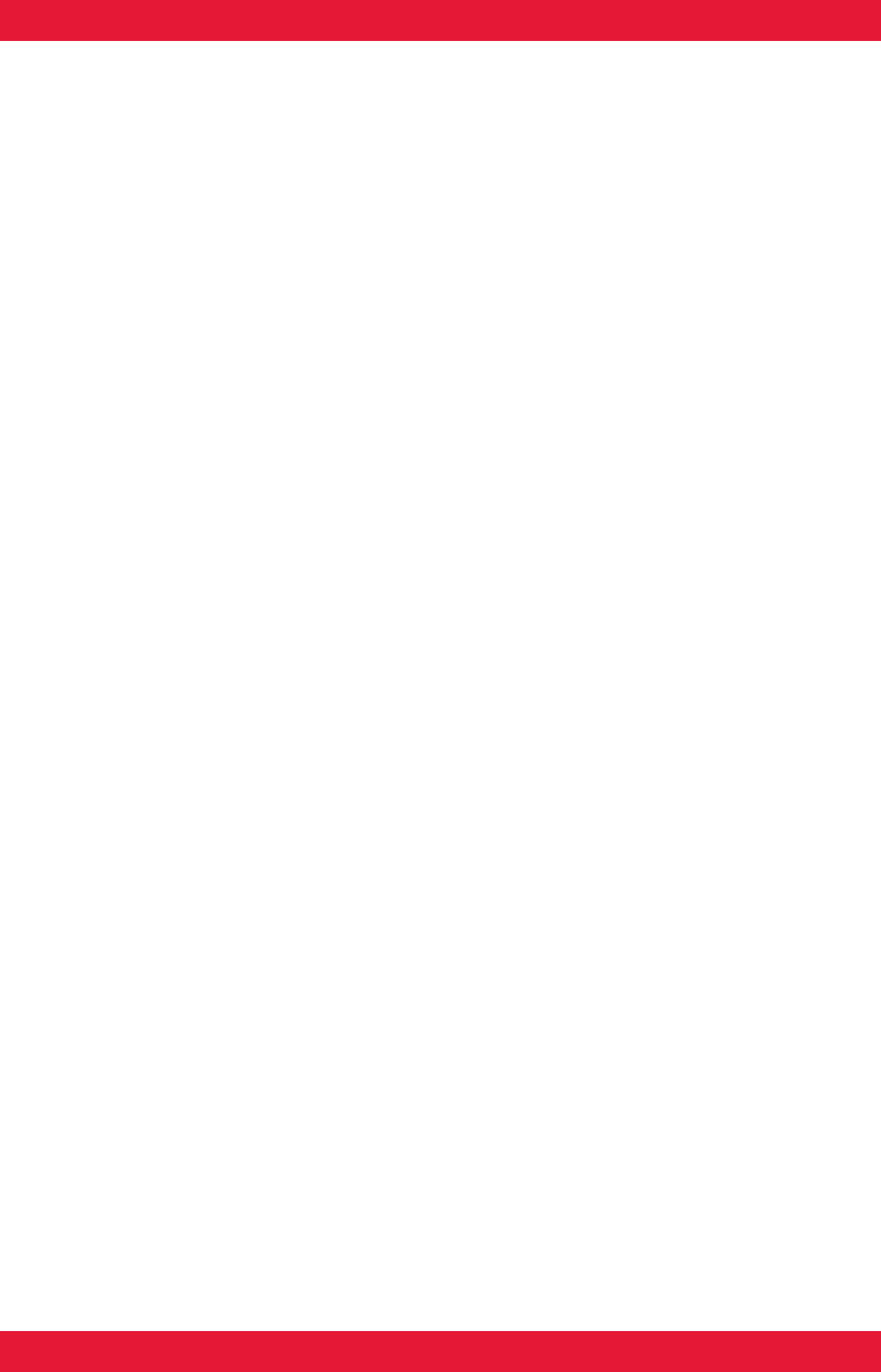

QUESTIONS?

Visit our website or contact us for more information about how to vote safely during the pandemic

elections.bc.ca | 1-800-661-8683

Translations of this guide are available at
elections.bc.ca/translations.

Follow Elections BC on social media:

    @ElectionsBC



ELECTIONS BC
A non-partisan Office of the Legislature